

A NEW LIDL FOR DOWNHAM MARKET



Site Background

Lidl are planning to deliver a new Lidl store on the southern side of Bexwell Road in Downham Market, approximately 150m to the south-west of the A10 / Bexwell Road roundabout. The site is currently an undeveloped parcel of land.

The Proposal

Lidl propose to develop a new store on the site, which will feature an attractive glazed frontage and car parking area with high quality landscaping. Access to the site will be taken from Bexwell Road.

The new food store will extend to 2,175 sq.m gross internal area (GIA) with a net sales area of 1,414 sq.m. The new foodstore will be supported by a total of 138 car parking spaces which includes 6 dedicated disabled spaces, 2 Electric Vehicle Charging (EVC) and 8 Parent & Child spaces.

It is proposed that the Lidl store will be open between the hours of:

- 7 am to 11pm Mondays to Saturdays (including Bank Holidays); and
- 10am to 4pm Sundays.

The store would normally receive a maximum of two deliveries per day. All store waste will be stored internally within the warehouse area and will be collected by the delivery vehicle, therefore minimising HGV movements within the site.

Site Plan

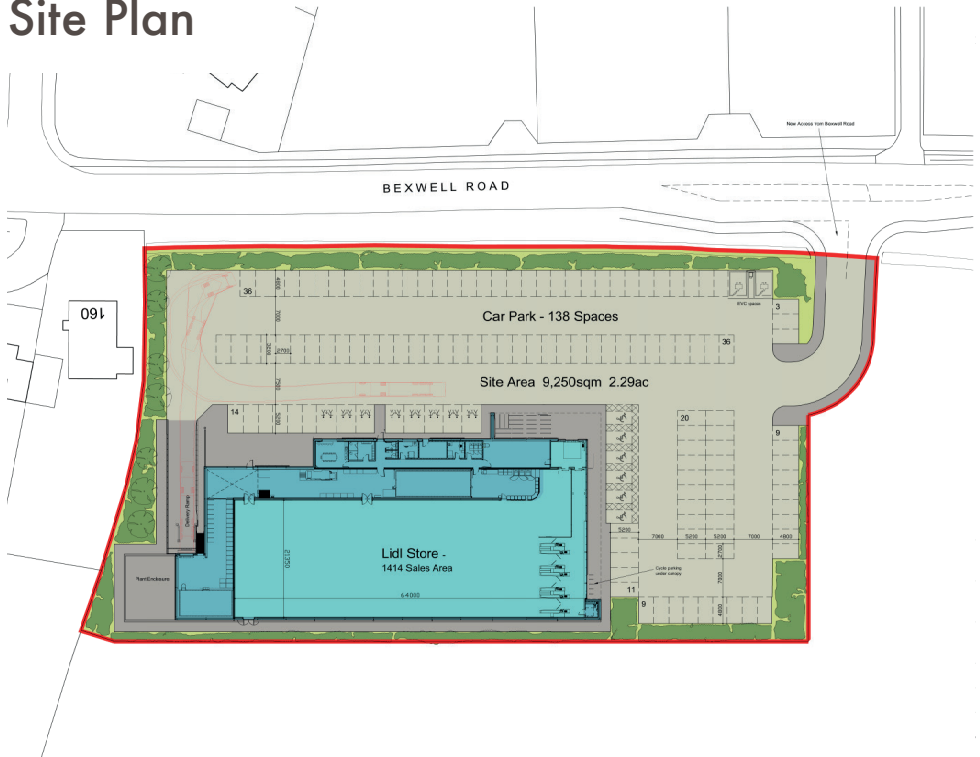

Benefits of the Proposed Development

The new Lidl store will provide the following benefits to the local area:

- A brand new store that will provide a clean and fresh shopping experience to meet the needs of customers;
- A dedicated in-store bakery;
- Improved shopping choice and provision of a new mainstream discount store;
- A contemporary building design that will benefit the surrounding area;
- Rapid electric vehicle charging points;
- Employment opportunities for local residents; and
- Living Wage Foundation rate for all eligible employees and no zero hours contracts.

About Lidl

We opened our first Lidl supermarket in Germany in 1973. Following positive customer feedback, we quickly expanded and by the 1980s, Lidl had become a household name.

Our first Lidl in the UK opened in 1994 and we have over 800 stores across Britain now. Lidl Great Britain has experienced continued growth over the years as consumers flock to the supermarket to discover its great value products – more than two thirds of which are British sourced – ranging from quality fruits and vegetables, to premium wines from its much coveted Wine Tour collections.

Lidl takes pride in providing top quality products at the lowest prices. Our stores are operated by a network of dedicated store staff, helping to establish and develop the success of the company.



Have Your Say

At Lidl, we know our success depends on the people we work with and the people who choose to shop with us. We recognise that providing high quality products at industry leading prices is only part of the story; the environment in which our customers do their shopping completes the experience. We would like to invite you to provide us with your thoughts on our proposal to open a new Lidl store on Bexwell Road.

For more information: <https://rapleys.com/consultation/lidl-downham-market>

Please register your support and provide any comments online using the web address or QR code below:



Register your comments: <https://tinyurl.com/Lidldownhammarket>
or email us at lidldownhammarket@rapleys.com

Alternatively, if you do not have access to the internet, you can also provide your comments via telephone using this number: **0161 817 6255**.

We would welcome your comments on our new store proposal by **21st October 2020**, as all feedback will be taken into consideration, and where possible and appropriate, used to make changes to our plans.

We hope that the planning application will be received and validated by King's Lynn & West Norfolk Borough Council by the end of October 2020.