



Key

Pedestrian audit of the route between the Station, Racecourse and town centre with improved footway where needed

New crossing to provide safe & convenient pedestrian access to Esher station

Site 4 - Residential development designed to provide natural surveillance on Station Road which will improve safety and the pedestrian environment

Site 5 - Residential development designed to provide natural surveillance on Portsmouth Road which will improve safety and the pedestrian environment

Clean out drains on the corner of Station Road and Portsmouth Road to alleviate flooding on the footway

Improved bus stop with a shelter and lighting. This will also improve the pedestrian environment on Portsmouth Road

Informal pedestrian crossing will improve access between existing homes on the southern side of Portsmouth Road, the Racecourse and Station

Site 2 - Residential development designed to provide natural surveillance on Portsmouth Road which will improve safety and the pedestrian environment

Removal of close boarded fencing to provide natural surveillance from Racecourse which will improve safety and the pedestrian environment

T:\30000_Projects\30918 Sandown Park Racecourse, Esher\ACAD\045_A.dwg

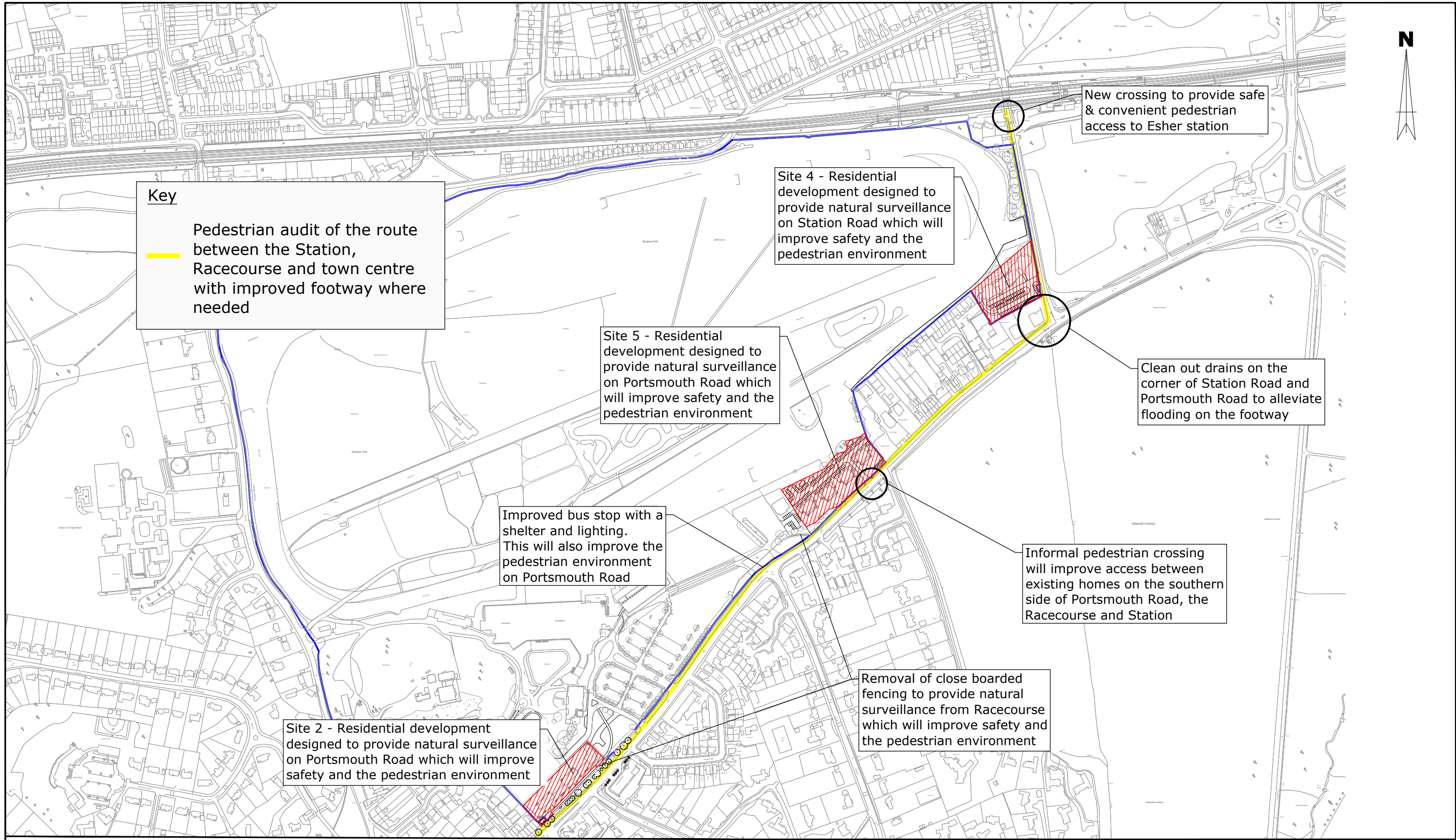

This drawing has been prepared for planning purposes and should not be used for construction.

BASED ON ORDNANCE SURVEY MAPPING AND REPRODUCED BY TRANSPORT PLANNING PRACTICE WITH THE PERMISSION OF THE CONTROLLER OF HMSO © CROWN COPYRIGHT
Based on layout, drawing number 11071fe_101 - masterplan.
TPP REF - IN_69.

SANDOWN PARK RACECOURSE

Measures proposed to improve connections between Esher Station, Sandown Park Racecourse and Esher Town Centre

TRANSPORT PLANNING PRACTICE

70 Cowcross Street
London, EC1M 6EL
t: 020 7608 0008
w: www.tppweb.co.uk



SCALE @ A3 1/5000	DATE 11/09/19	DRAWN BY LD	CHECKED ML	DRAWING NUMBER 30918/AC/045	REV A
----------------------	------------------	----------------	---------------	--------------------------------	----------