

Have Your Say

Dalmarnock, Glasgow

- Have your say about our proposed development by filling in the form overleaf
- Then detach this page, fold in half with the Freepost address showing
- Seal it with a strip of sticky tape
- Pop it into the letterbox—no postage required

2

Freepost Plus RUCC-TGXY-BUHS
Lidl DALMARNOCK
11 Titan Drive
Peterborough
PE1 5XN



Lidl Scotland

Since opening our first store in Scotland in 1994, we have steadily expanded and now operate over 100 stores across Scotland. Our expansion has only been possible thanks to the help and support of the local communities which we serve. We are very proud of our success in Scotland and the relationships that we have formed with Scottish suppliers and local communities.

With a large range of products sourced from over 80 Scottish suppliers, we are committed to providing customers with the best quality, fresh produce at great prices.

Alongside our own brand products, we also offer our customers some of Scotland's biggest brands at trademark Lidl prices. Customers can enjoy a wide range of 100% Scottish beef, lamb and pork, as well as an extensive range of fresh fruit and vegetables, bread and cakes, and chilled and frozen products.



Every week we offer an array of outstanding promotions on some of the nation's favourite brands. Offers also include our 'Pick of the week', where we offer a variety of fresh fruit and vegetables at reduced prices, all week long!

In fact, the products sourced from Scotland are of such fantastic quality that many are exported to over 9,500 Lidl stores across Europe - something both Lidl and Scotland can be proud of!



Lidl have introduced in-store bakeries in all Scottish stores. Your new store at Dalmarnock would benefit from a bakery offering freshly baked products through-out the day. The bakery would stock a wide range of goods from baguettes to doughnuts and cheese twists to Scottish morning rolls.



Have Your Say



A new development for Dalmarnock

Proud to serve Scotland

The Proposed Development

Community Consultation



We Welcome Your Views

Have Your Say

Lidl has submitted a planning application for a new dedicated Lidl store on Dalmarnock Road, Dalmarnock. As part of the application process, we are seeking feedback from the local community on the proposals.

Site Background

The site is adjacent to the Esso petrol filling station (377 Dalmarnock Road) and occupies a central position at the junction of Springfield Road and Dalmarnock Road. The site is accessible by both bus and train with Dalmarnock Station being located 80m away.

The site was formerly occupied by a bus depot and more recently was used temporarily in connection with the 2014 Glasgow Commonwealth Games. All buildings have been demolished with hardstanding remaining on site.

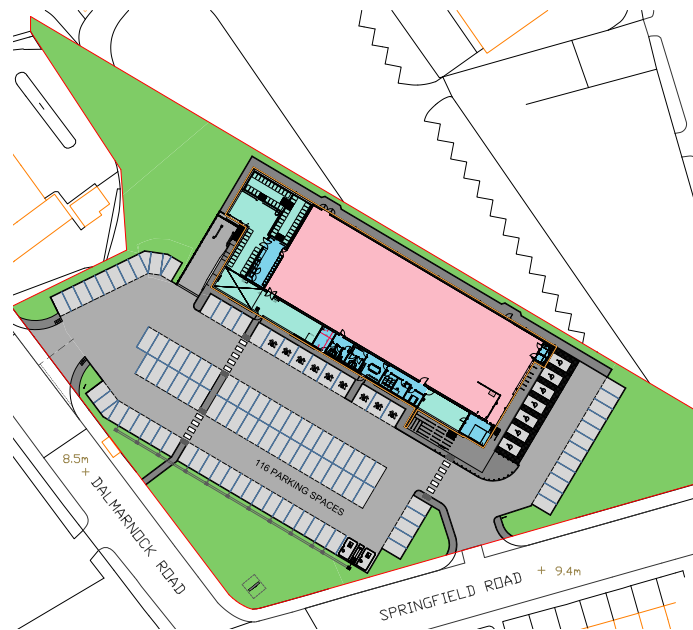

The Proposal

The proposal is for a 1,265 sq.m sales area Lidl foodstore together with 116 parking spaces including dedicated disabled bays, parent and child bays. The store will also feature 2 electric vehicle charging spaces and array of solar panels on the roof. Vehicular and pedestrian access to the store is proposed from both Dalmarnock Road and Springfield Road.

Benefits of the Proposed Development

The proposal will bring a number of benefits to the locality, including:

- Maximising the use of a historically vacant and unused site;
- The creation of jobs locally through the construction process and employment opportunities once the development has been completed;
- Supporting the ongoing regeneration of the Clyde Gateway area; and
- Providing a convenient foodstore facility for the expanding local community.

Specifically, the new Lidl store will provide the following benefits to the local area:

- A brand new store that will provide a clean and fresh shopping experience to meet the needs of customers;
- A dedicated in-store bakery;
- A sustainable store with roof mounted solar panels providing up to 25% of the store's electricity supply;
- A contemporary building design that will complement the surrounding area;
- Employment opportunities for local residents; and
- Over Living Wage Foundation hourly rate, starting at £9.50 for all eligible employees and no zero hours contracts.

Have Your Say

We welcome your comments on the information contained in this leaflet and we would be grateful if you could complete our online survey via this link: <https://ntgt.de/a/s.aspx?s=454710X96989124X54660> or scan the QR code opposite.



We will also be holding a virtual event using Microsoft Teams on Wednesday 24 November between 4pm – 7pm.

To join the meeting(s) please visit the website (details provided below) and click on the link in the 'Have your say' section.

We have created a dedicated website with information about the proposal, full suite of plans, visuals and other useful information and the opportunity to give us your views. The details are as follows:

Website: <https://www.rapleys.com/consultation/lidldalmarnock>

Email: lidldalmarnock@rapleys.com

Subject Title - "Proposed Lidl Foodstore and Mixed Use Development – Dalmarnock"

Freepost returns: **Please see details overleaf**

We would ask that comments are sent back to us no later than the **29 November 2021**. We will review all comments as part of the consideration of the planning application.

We Value Your Views

At Lidl we know our success depends on the people we work with and the people who choose to shop with us. We recognise that providing high quality products at industry leading prices is only part of the story; the environment in which our customers do their shopping completes the experience.

We would like to invite you to provide us with your thoughts on our proposal to develop a new foodstore at Dalmarnock.

We are interested to hear what the local community has to say about our proposal for Dalmarnock, please use this pre-paid postal form to reply to us directly.

Where do you do the majority of your food shopping? Please select one option:

- ☐ Lidl ☐ Co-op ☐ Sainsbury's ☐ Aldi ☐ Morrisons ☐ M&S ☐ ASDA ☐ Tesco
☐ Other - please specify: _____

Are you supportive of the a new Lidl store in this location? ☐ Yes ☐ No ☐ Undecided

What is your overall opinion of the proposed development of this site?

- ☐ Support ☐ Do not support ☐ Undecided

Do you have any further comments to make? _____

Thank you for taking the time to complete our survey!

For quality assurance purposes your views can only be recorded if you provide contact details (this information will be held in the strictest confidence by Lidl c/o Rapleys LLP) in line with GDPR.

Title: _____ Name: _____

Address: _____

Email Address: _____

How would you like us to keep you updated on the progress of our proposed development? ☐ Post ☐ Email ☐ Please do not contact me.

