

Have Your Say

Perth

- Have your say about our proposed development by filling in the form overleaf
- Then detach this page, fold in half with the Freepost address showing
- Seal it with a strip of sticky tape
- Pop it into the letterbox—no postage required



Freepost Plus RUCC-TGXY-BUHS
Lidl Perth
11 Titan Drive
Peterborough
PE1 5XN



Lidl Scotland

Since opening our first store in Scotland in 1994, we have steadily expanded and now operate over 100 stores across Scotland. Our expansion has only been possible thanks to the help and support of the local communities which we serve. We are very proud of our success in Scotland and the relationships that we have formed with Scottish suppliers and local communities.

With a large range of products sourced from over 80 Scottish suppliers, we are committed to providing customers with the best quality, fresh produce at great prices.

Alongside our own brand products, we also offer our customers some of Scotland's biggest brands at trademark Lidl prices. Customers can enjoy a wide range of 100% Scottish beef, lamb and pork, as well as an extensive range of fresh fruit and vegetables, bread and cakes, and chilled and frozen products.



Your new store at Perth would benefit from a bakery offering freshly baked products through-out the day. The bakery would stock a wide range of goods from baguettes to doughnuts and cheese twists to Scottish morning rolls.



Every week we offer an array of outstanding promotions on some of the nation's favourite brands. Offers also include our 'Pick of the week', where we offer a variety of fresh fruit and vegetables at reduced prices, all week long!

In fact, the products sourced from Scotland are of such fantastic quality that many are exported to over 9,500 Lidl stores across Europe - something both Lidl and Scotland can be proud of!



Proud to serve Scotland



Have Your Say



A new development for Perth

The Proposed Development

Community Consultation



We Welcome Your Views

Have Your Say

Lidl is proposing to submit a planning application for a new dedicated Lidl store on Crieff Road, Perth. As part of the application process, we are seeking feedback from the local community on the proposals.

Site Background

The site is located to the north of Crieff Road (A85) and lies to the east of Newton Farm. Residential properties and Nationwide Crash Repair Centre is situated opposite the site. St Johnstone Football Club's stadium is located behind the proposed Lidl store.

The site is currently grassland following the A85 re-alignment and link road to the A9. The site is highly accessible having a regular bus service to Perth along Crieff Road as well as convenient road access.

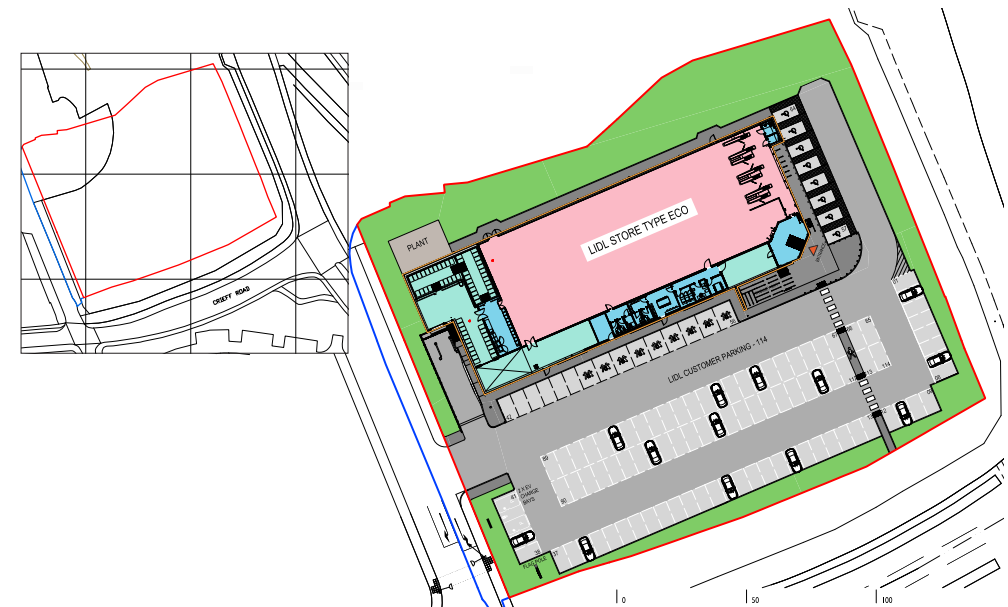

The Proposal

The proposal is for a 1,251 sq.m sales area Lidl foodstore together with 114 parking spaces including 8 dedicated accessible bays, 9 parent and child bays as well as 2 electric charging bays with the capacity to add more in the future. The store will feature solar panels providing up to 25% of the store's electricity supply.

Benefits of the Proposed Development

The proposal will bring a number of benefits to the locality, including:

- The creation of jobs locally through the construction process and employment opportunities once the development has been completed;
 - Provide a convenient additional choice foodstore facility for the expanding local community; and
 - Provide customers with a discount supermarket that offers good quality products at the lowest possible price.
- clean and fresh shopping experience to meet the needs of customers;
- A supermarket in a convenient location that is accessible by a number of transport methods;
 - A dedicated in-store bakery;
 - A sustainable store with roof mounted solar panels providing up to 25% of the store's electricity supply;
 - A contemporary building design that will complement the surrounding area;
 - Employment opportunities for local residents; and
 - Over Living Wage Foundation hourly rate, starting at £10.10 from March 2022 for all eligible employees and no zero hours contracts.
- Specifically, the new Lidl store will provide the following benefits to the local area:
- A brand new store that will provide a

Have Your Say

We welcome your comments on the information contained in this leaflet and we would be grateful if you could complete the form attached and post using our freepost service, alternatively you can complete our online survey via this link:

<https://ntgt.de/ra/s.aspx?s=457739X97585832X74466>
or scan the QR code opposite.



We will also be holding a virtual event using Microsoft Teams on **Tuesday 18 January** between **4pm – 7pm**.

To join the meeting please visit the website (details provided below) and click on the link in the 'Have your say' section.

We have created a dedicated website with information about the proposal, full suite of plans, visuals and other useful information and the opportunity to give us your views. The details are as follows:

Website: <https://www.rapleys.com/consultation/lidlperth>

Email: lidlperth@rapleys.com

Subject Title - "Proposed Lidl Foodstore – Perth"

Freepost returns: **Please see details overleaf**

We would ask that comments are sent back to us no later than the **28 January 2022**.

We Value Your Views

At Lidl we know our success depends on the people we work with and the people who choose to shop with us. We recognise that providing high quality products at industry leading prices is only part of the story; the environment in which our customers do their shopping completes the experience.

We would like to invite you to provide us with your thoughts on our proposal to develop a new foodstore at Perth.

We are interested to hear what the local community has to say about our proposal for Perth, please use this pre-paid postal form to reply to us directly.

Where do you do the majority of your food shopping? Please select one option:

- Lidl Co-op Sainsbury's Aldi Morrisons M&S ASDA Tesco
- Other - please specify: _____

Are you supportive of the new Lidl store in this location? Yes No Undecided

Do you have any further comments to make? _____

Thank you for taking the time to complete our survey!

For quality assurance purposes your views can only be recorded if you provide contact details (this information will be held in the strictest confidence by Lidl c/o Rapleys LLP) in line with GDPR.

Title: _____ Name: _____

Address: _____

Email Address: _____

How would you like us to keep you updated on the progress of our proposed development? Post Email Please do not contact me.

